

# MURRAY

## MURRAY CORPORATION Nut Runner & Clamp Key

### "Flexible Clamp Driver"/Nut Runner A6000000C



Provides easy access for installation or removal in tight spaces and odd angles. Perfect for working on crowded engine compartments and plumbing repair applications. The reversible socket works with both standard 5/16" size and mini 1/4" hose clamp screws.

- 90 degree access
- Non-slip handle
- Hollow 6" flexible shaft
- Nickel plated steel

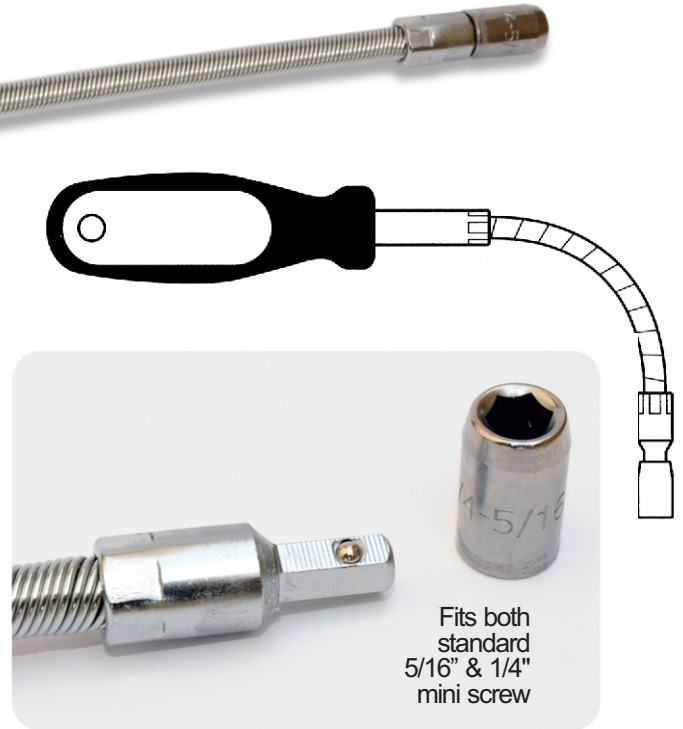

Fits both  
standard  
5/16" & 1/4"  
mini screw

### Murray Clamp Key 90003100P10

- Murray Clamp Key makes installation quick with a simple twist of the hand.
- Easy to remove/replace and is reusable.
- Produces an installation torque of 30-35 in. lbs.
- Compatible with all Murray Clamps that use a 5/16 inch screw.



MURRAY

260 Schilling Circle  
Hunt Valley, MD, 21031, USA

Ph: 410-771-0380 • Fax: 410-771-5576  
www.murraycorp.com • email: sales@murraycorp.com